

2-PART SHADOW-GAP MDF DOORFRAME FD30

2X DOUBLE DOORS - MINIMUM CENTRAL PARTITION

Plan Detail

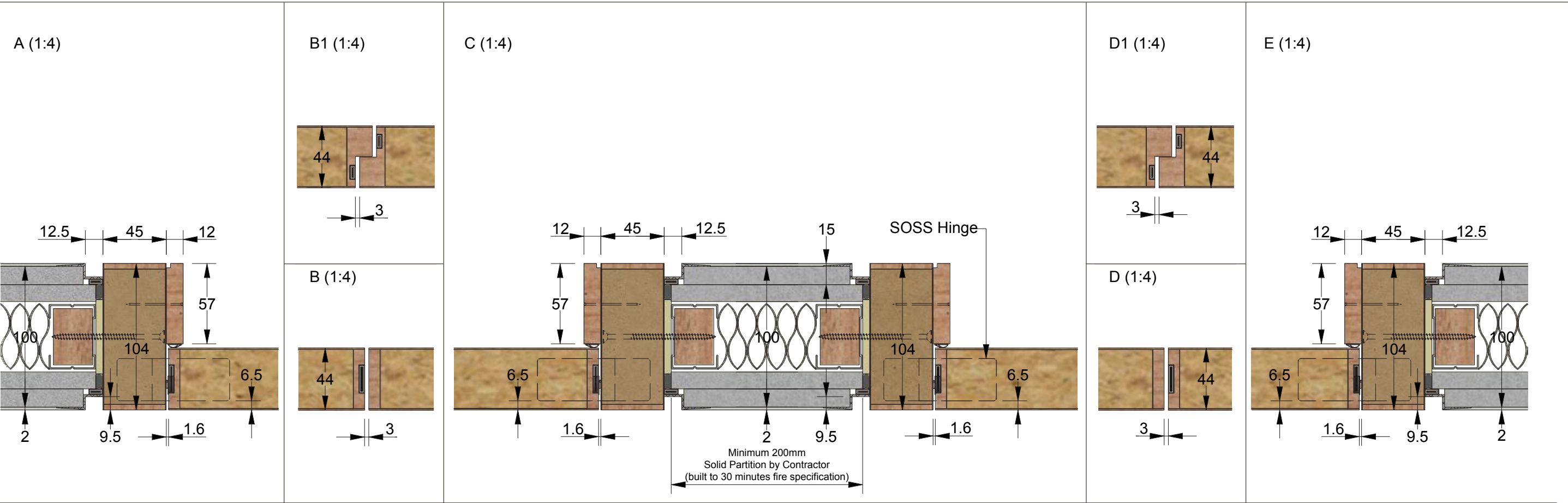
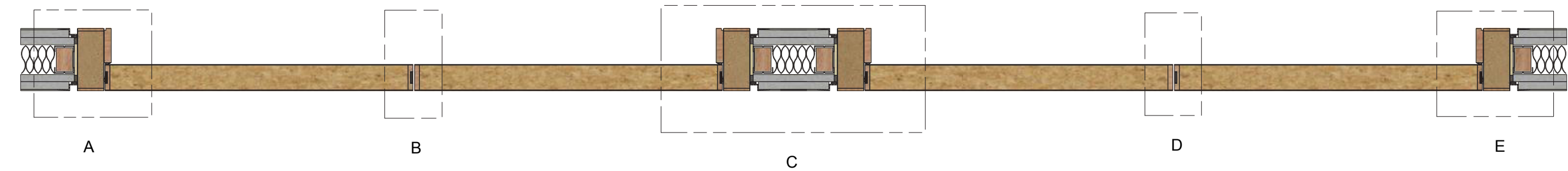

Specification

Door:	Timber Particle Board
Liner:	MDF
Stop/Architrave:	Solid Timber
	Mineral wool
	Intumescent mastic



20x4mm Intumescent 10x4mm Intumescent

Title	2-Part Shadow-gap Doorframe FD30		
Code			
Sheet	1 of 1	Date	10/02/2019
Issue	2	Dwg No	FZD0697



forza-doors.com
01403 711 126
sales@forza-doors.com