

# TIMBER DOORFRAME FD30

## 2X DOUBLE DOORS MINIMUM CENTRAL PARTITION WIDTH

Plan Detail

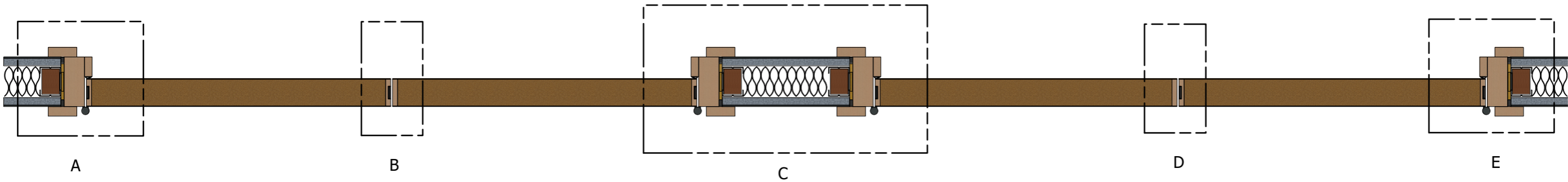

Detail A

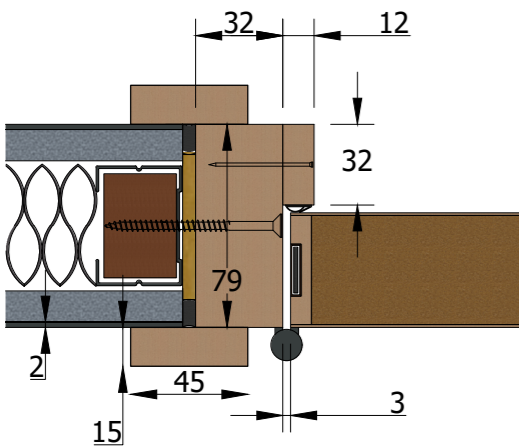

Detail B1

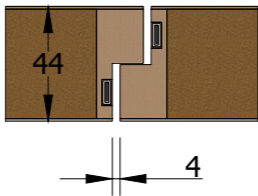

Detail B

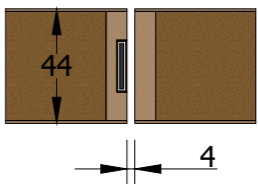

Detail C

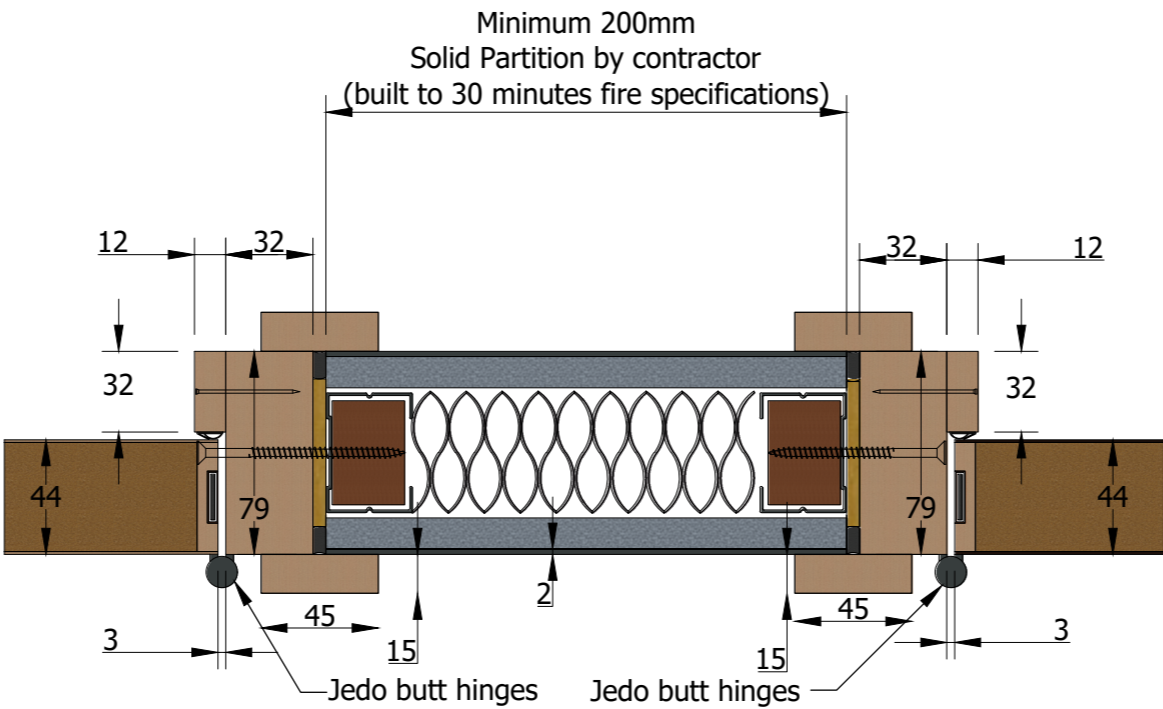

Detail D1

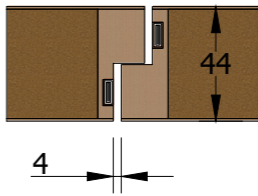

Detail D

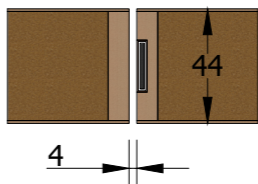

Detail E

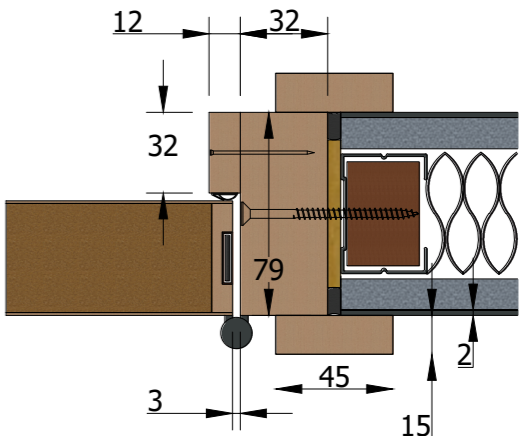

### Specification

Door:	Timber Particle Board
Liner:	Solid Timber
Stop/Architrave:	Solid Timber
	Mineral wool
	Intumescent mastic

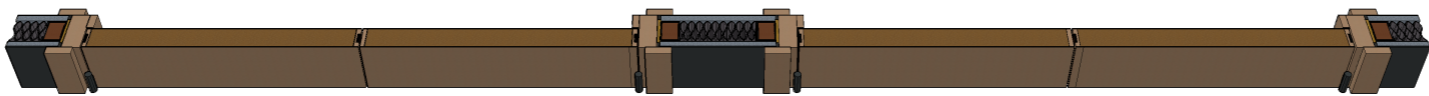

20x4mm Intumescent 10x4mm Intumescent

Title	Back to Back Double Doorframe FD30		
Code			
Sheet	1 of 1	Date	20/01/2023
Issue	V1	Dwg No	FZD5502



forza-doors.com  
01403 711 126  
sales@forza-doors.com